

KombiSIGN 50 / Accessories

## Contact box for cable exit at side



**Part No.:** 975.840.01

### MECHANICAL DATA

|                       |                     |
|-----------------------|---------------------|
| Height                | 29 mm               |
| Diameter              | 70 mm               |
| Materials             | PA-GF               |
| Housing colour        | Black               |
| Protection category   | IP54                |
| Cable entry           | Screwed cable gland |
| Cable entry minimum   | d = 5 mm            |
| Cable entry maximum   | d = 10 mm           |
| Weight with packaging | 71 g                |
| Product weight        | 71 g                |

### APPROVAL DATA

|                               |                                |
|-------------------------------|--------------------------------|
| Conforms with CE              | No                             |
| Conforms with RoHS directive  | Fulfills substance restriction |
| WEEE                          | No                             |
| Conforms with ATEX-directive  | No                             |
| Conforms with CCC             | No                             |
| Conforms with UL              | No                             |
| Conforms with FCC             | No                             |
| Conforms with IC              | No                             |
| EAC certificate available     | No                             |
| Conforms with UKCA (Importer) | No                             |
| Conforms with AS-I            | No                             |
| ICAO Certification            | No                             |
| Conforms with DNV             | No                             |
| Conforms with RoHS CN         | No                             |



For additional installation and mounting information, refer to the appropriate user guide at [www.werma.com](http://www.werma.com). This printed copy is for information only and is subject to alteration.

KombiSIGN 50 / Accessories

## Contact box for cable exit at side

### DRAWING

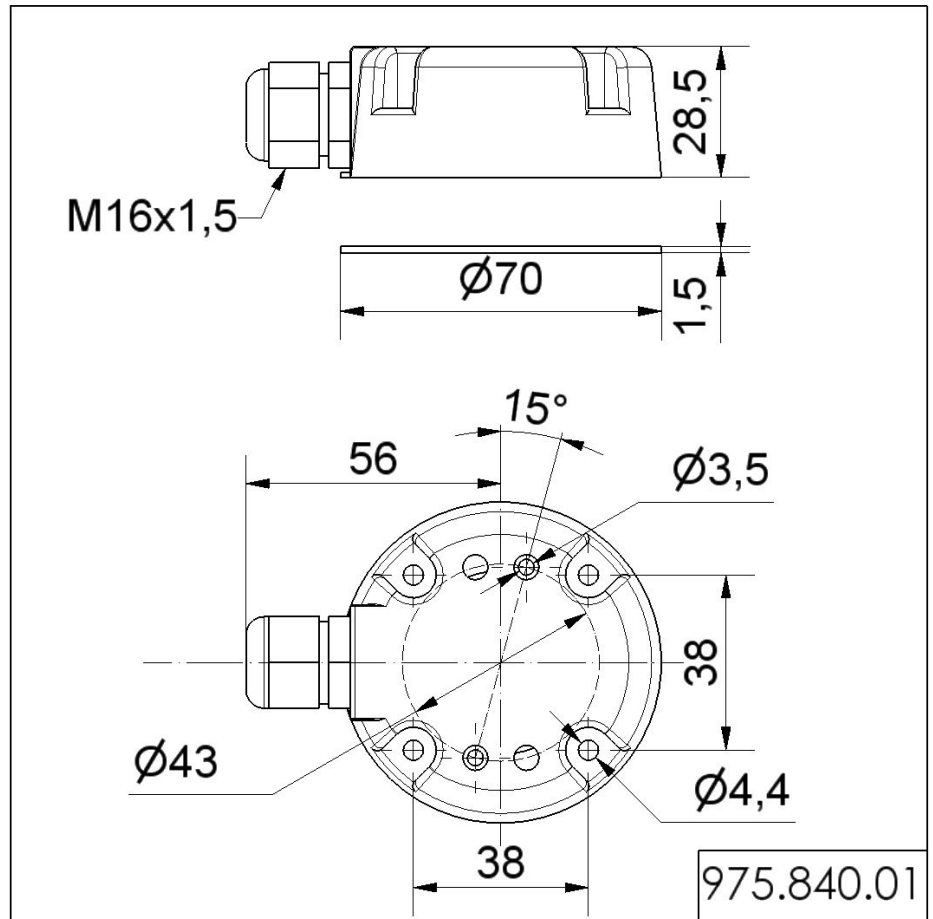

For additional installation and mounting information, refer to the appropriate user guide at [www.werma.com](http://www.werma.com). This printed copy is for information only and is subject to alteration.